

# TELLING PRODUCT SUBMITTAL DATA

## TELLING PART #: TRC14X Series B

**MATERIAL:** 12ga (97 mil), 14ga (68 mil), 16ga (54 mil)

**COATING:** galvanized G60 and G90

### STEEL SPECIFICATIONS:

1. Steel meets ASTM A1003, Grade 50 Type H (ST50H).
2. Coating meets ASTM A1003, A653 for either G60, G90, or equivalent.



### TELLING RIGID CLIP ALLOWABLE CAPACITIES (LBS)

PART#	CLIP THK. (MIL)	Yield F(y)	Tensile	Length (in)	A (in)	#10-16 SCREWS	STUD								
							33 mil (20 ga)			43 mil (18 ga)			54 mil (16 ga)		
							F1	F2	F3	F1	F2	F3	F1	F2	F3
TRC143	54 (16ga)	50 ksi	65 ksi	3.5	1.25	4	400	213	705	596	213	827	1100	213	827
						6	429	213	827	638	213	827	1100	213	827
	68 (14ga)	50 ksi	65 ksi	3.5		4	400	338	705	596	338	1052	1174	338	1185
						6	429	338	1060	638	338	1185	1174	338	1185
	97 (12ga)	50 ksi	65 ksi	3.5		4	400	689	705	596	689	1052	1211	689	2063
						6	429	689	1060	638	689	1578	1296	689	2063
TRC145	54 (16ga)	50 ksi	65 ksi	5.5	3.25	4	315	213	484	438	213	484	438	213	484
					2	6	481	213	635	713	213	635	713	213	635
	68 (14ga)	50 ksi	65 ksi	5.5	3.25	4	315	338	694	469	338	694	552	338	694
					2	6	481	338	911	716	338	911	898	338	911
	97 (12ga)	50 ksi	65 ksi	5.5	3.25	4	315	689	706	619	689	1052	788	689	1208
					2	6	481	689	1060	716	689	1578	992	689	1586
TRC147	54 (16ga)	50 ksi	65 ksi	7.5	5.25	4	258	213	370	271	213	370	271	213	370
					4	6	356	213	431	356	213	431	356	213	431
	68 (14ga)	50 ksi	65 ksi	7.5	5.25	4	258	338	530	342	338	530	342	338	530
					4	6	389	338	618	449	338	618	449	338	618
	97 (12ga)	50 ksi	65 ksi	7.5	5.25	4	258	689	706	385	689	923	488	689	923
					4	6	389	689	1060	579	689	1075	640	689	1075
TRC149	54 (16ga)	50 ksi	65 ksi	9.5	7.25	4	196	213	309	196	213	309	196	213	309
					6	6	237	213	343	237	213	343	237	213	343
	68 (14ga)	50 ksi	65 ksi	9.5	7.25	4	219	338	443	247	338	443	247	338	443
					6	6	299	338	492	299	338	492	299	338	492
	97 (12ga)	50 ksi	65 ksi	9.5	7.25	4	219	689	706	326	689	771	353	689	771
					6	6	325	689	857	427	689	857	427	689	857
TRC1411	54 (16ga)	50 ksi	65 ksi	11.5	9.25	4	154	213	269	154	213	269	154	213	269
					8	6	178	213	292	178	213	292	178	213	292
	68 (14ga)	50 ksi	65 ksi	11.5	9.25	4	189	338	386	194	338	386	194	338	386
					8	6	224	338	419	224	338	419	224	338	419
	97 (12ga)	50 ksi	65 ksi	11.5	9.25	4	189	689	672	277	689	672	277	689	672
					8	6	279	689	729	320	689	729	320	689	729

#### TABLE NOTES:

1. The tabulated clip capacity values are based on the AISI Research Report PR18-4 "Load Bearing Clip Angle Design" phase II and accepted industry design standards.
2. The anchor strength to the support must be calculated separately, the minimum of the tabulated clip capacity and the anchor strength must be used. Anchor strength may be less than the tabulated clip capacity.
3. Appropriate interaction equation must be used for clips subjected to the combined shear tension and compression forces.
4. All loads calculated by an independent third party PE engineer.

#### TRC CLIP

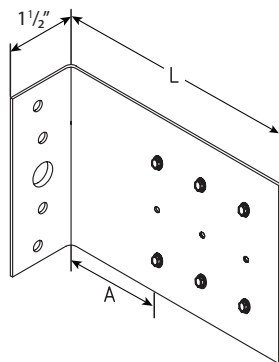

#### 6 SCREW PATTERN

(A = Measurement to first drill hole)

#### TRC APPLICATION

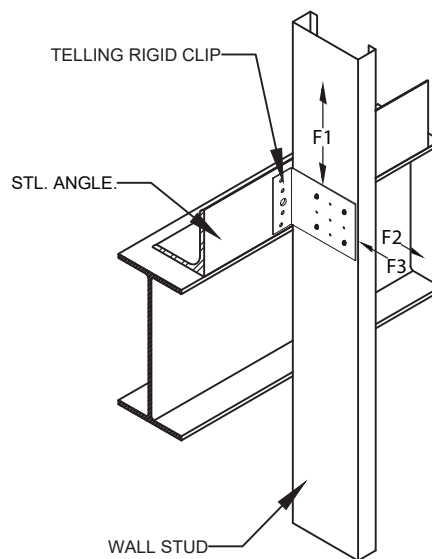

# INNOVATION, SERVICE, QUALITY

www.BuildStrong.com • 1-866-372-6384



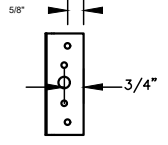
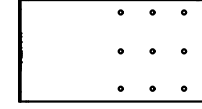
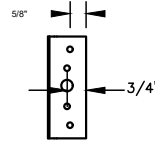
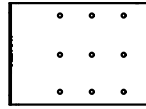
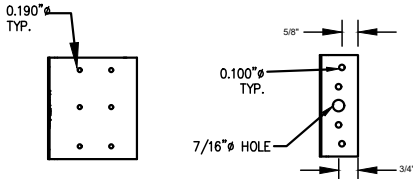
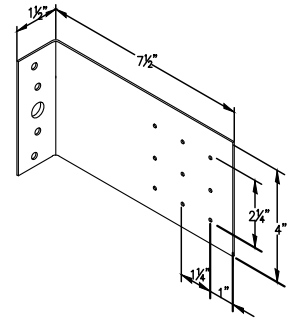
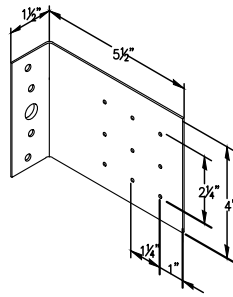
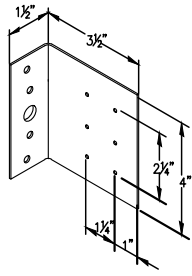

TRC 143

TRC 145

TRC 147

**MATERIAL SPECIFICATIONS**

DESIGN THICKNESS, YIELD, TENSILE

54 MIL (0.0566"), 50ksi, 65ksi

68 MIL (0.0713"), 50ksi, 65ksi

97 MIL (0.1017"), 50ksi, 65ksi

ASTM 1003, GRADE 50 TYPE H (ST50H)

G60 AND G90 HOT DIPPED GALVANIZED

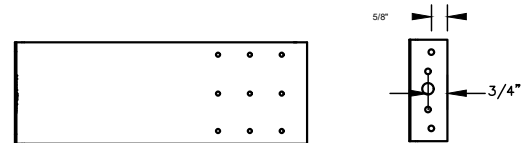
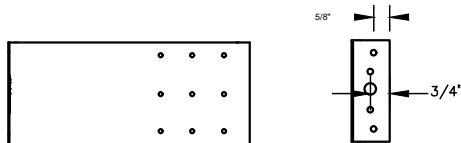
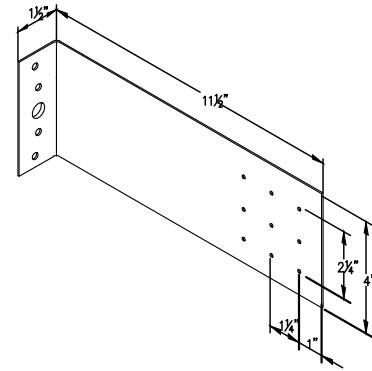
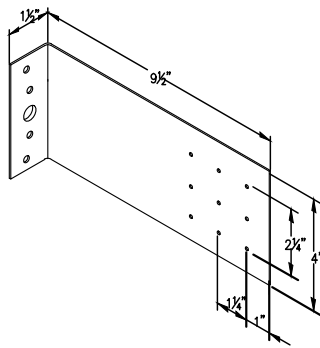

TRC 149

TRC 1411



**INNOVATION, SERVICE, QUALITY**

[www.BuildStrong.com](http://www.BuildStrong.com) • 1-866-372-6384

